



SUBMITTAL

TYPE: SSA ASME PRE-CHARGED EPOXY LINED SURGE ARRESTOR TANKS
MODELS: SSA 35E TO SSA 800LE

Submittal Sheet No. SSA-2016C

Date: Feb, 2016

JOB _____	AA tanks Representative _____	
Unit Tag No. _____	Order No _____	Date _____
Engineer _____	Submitted By _____	Date _____
Contractor _____	Approved By _____	Date _____

DESCRIPTION

AA tanks Type SSA Tanks are ASME replaceable bladder type pre-charged hydro-pneumatic tanks for commercial, industrial, municipal and well water systems, to effectively control water hammer shock, and pump start-up/shut-down water surge. The vessels are fabricated between 125 PSI and 500 PSI rating with a large water system connection designed to accept potentially harmful water surge pressures quickly, with minimal pressure drop.

CONSTRUCTION

Shell: Carbon Steel
(Available in 403 / 316 Stainless Steel)
External Finish: Primer
Internal Finish: Epoxy Lined (NSF 61)
System Connection: Epoxy Coated Carbon Steel
(Available in 304 / 316 Stainless Steel)
Level Gauge: Available upon request
Bladder: Heavy Duty Butyl
(NSF Certified / FDA Approved Materials)

PERFORMANCE LIMITATIONS

Maximum Design Pressure: 125 To 500 PSIG
Maximum Design Temperature: 240°

Model Number	Tank Volume (Gallons)	Tagging Information	Quantity
SSA 35E	10		
SSA 50E	13		
SSA 85E	23		
SSA 130E	35		
SSA 200E	53		
SSA 300E	79		
SSA 400E	106		
SSA 500E	132		
SSA 600E	158		
SSA 700E	185		
SSA 800LE	211		

TYPICAL SPECIFICATION

Furnish and install, as shown on plans, a _____ gallon _____" diameter X _____" (high) pre-charged surge arrestor tank with heavy-duty butyl bladder. The tank shall have NPT, flanged or grooved system connections and a 0.302"-32 charging valve connection (standard tire valve) to facilitate the on-site charging of the tank to meet system requirements. The tank must be constructed in accordance with most recent addendum of Section VIII Division 1 of the ASME Boiler and Pressure Vessel Code.

Each tank shall be AA tanks model number SSA-_____ or approved equal.



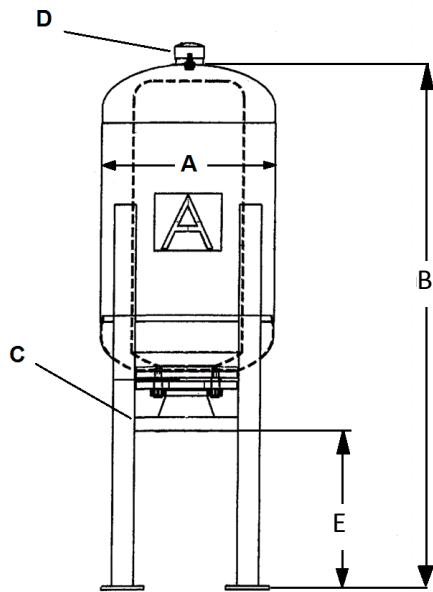

SSA 35 & SSA 50

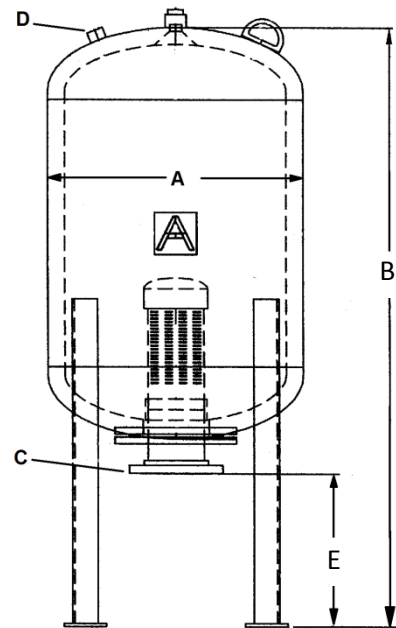

SSA 85 to SSA 800L

DIMENSIONS & WEIGHTS

Model Number	Tank Volume Gallons	Dimensions in Inches					Approx. Shipping Weight (lbs)
		Diameter	OAL	System Connection	Charging Valve	E	
		A	B	C	D		
SSA 35E	10	12	39	2 1/2	0.302" -32NC	12	63
SSA 50E	13	14					74
SSA 85E	23	16	46	3			116
SSA 130E	35	20					135
SSA 200E	53	24	52	4			250
SSA 300E	79		64				360
SSA 400E	106	30	58	6			430
SSA 500E	132		65 1/2				525
SSA 600E	158	73 1/2	640				
SSA 700E	185	79	749				
SSA 800LE	211	32	84	760			

NOTES:

- Tanks are factory pre-charged to 30 PSI and field adjustable.
- G-Grooved Pipe / F-Flanged / NPT system connection available.
- Available with base ring.
- "E" Dimension adjusted to spec
- All SSA tanks are built to order.